



POWERSCOURT
HOTEL RESORT SPA





Nestled among ancient trees, within the granite walls of one of Ireland's renowned estates you will find the five-star Powerscourt Hotel, Resort & Spa.

With 198 lavishly furnished guest rooms including 92 suites and 36 holes of Championship-quality golf, the resort is a stunning complement to the sublime formal gardens of historic Powerscourt Estate in County Wicklow. Business and leisure visitors enjoy impeccable service and a wealth of comforting amenities including three delectable dining options, a pampering Spa, a state-of-the-art Fitness Suite, and exciting recreation options.

From the historic 17th century Powerscourt House, with its beautifully manicured gardens, Powerscourt Whiskey Distillery and the highest waterfall in Ireland, there is an array of options to discover. Offering a range of estate activities from falconry, archery, and 4 x 4 driving, all within the walls of this historic 1,000 acre Wicklow Estate.

LOCATION

South of Dublin in the region known as the Garden of Ireland – 30 minutes from the city centre, 40 minutes from Dublin International Airport.

ACCOMMODATION

Powerscourt Hotel offers 198 distinctive guest rooms, including 92 suites. All rooms are opulently furnished and are some of the largest hotel rooms in Ireland, with the entry level Deluxe rooms 45 square metres/504 square feet in size, and Suites from 65 square metres/731 square feet. Many of these hotel rooms feature floor-to-ceiling windows, panoramic views and terraces.

DINING

Sika Restaurant – with an emphasis on local excellence and seasonality, Sika Restaurant and Terrace at Powerscourt Hotel offers superior Irish contemporary cooking set against a spectacular backdrop.
The Sally Gap Bar & Brasserie – with its casual atmosphere, is designed to make you feel at home, with warm lighting, comfortable seating, and a friendly ambience.
Sugar Loaf Lounge – where exquisite afternoon tea is served and mouth-watering cocktails are prepared.
ESPA Café – offering health oriented breakfast and lunch to guests during their spa retreat.

MEETING & EVENTS AMENITIES

More than 1,111 sq metres/ 12,030 sq feet of meeting and conference space
558 sq metre/5,959 sq foot Ballroom dividable into three salons
12 meeting rooms
Outdoor "secret" garden available for events and receptions
Private entrance to all meeting and conference facilities
Business centre
High Speed 60mb bandwidth WiFi
17th Century Powerscourt House Ballroom for off-site events
On-site audiovisual expertise
Dedicated Meetings & Events planner

2ND FLOOR

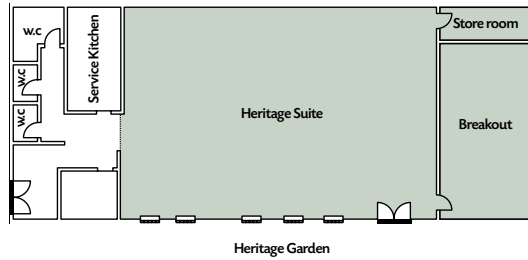

5TH FLOOR

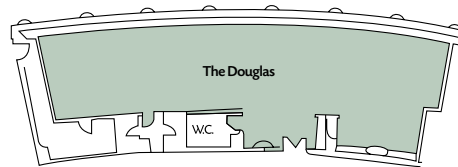

3RD FLOOR

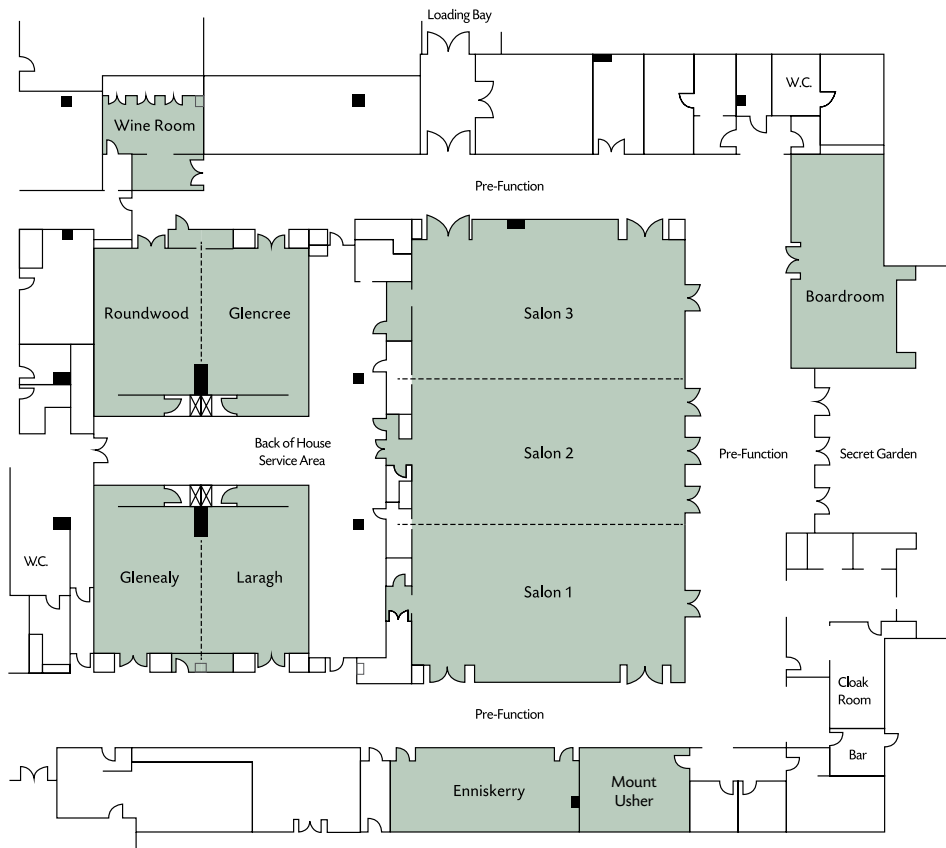

MEETING SPACE

Room	Dimensions		Ceiling Height				Seating Capacity									
	Sq ft	Sq m	ft	m	ft	m	Reception	Banquet Seating	Theatre Seating	Classroom Seating	U-Shape Seating	Boardroom Seating	Hollow Seating	Cabaret Seating		
Ballroom	5,959	558	59x101	18x31	12	4	600	400	500	240	72	80	-	186		
Salon 3	1,888	189	59x32	18x10.5	-	-	200	120	200	80	32	38	38	60		
Salon 2	1,711	169	59x29	18x9.4	-	-	200	140	200	80	32	38	38	60		
Salon 1	1,888	189	59x32	18x10.5	-	-	200	120	200	80	32	38	38	60		
Glencree	667	63	29x23	9x7	7	2	50	36	56	24	18	20	24	18		
Roundwood	667	63	29x23	9x7	7	2	50	36	56	24	18	20	24	18		
Glencree & Roundwood (combined)	1,334	126	29x46	9x14	-	-	100	96	120	36	30	30	40	36		
Laragh	667	63	29x23	9x7	7	2	50	36	56	24	18	20	24	18		
Gleenealy	667	63	29x23	9x7	7	2	50	36	56	24	18	20	24	18		
Laragh & Gleenealy (combined)	1,334	126	29x46	9x14	-	-	100	96	120	36	30	30	40	36		
Enniskerry	560	55	40x14	4.5x12.4	8	2	50	36	60	30	21	24	-	24		
Boardroom	810	80	45x18	14x5.7	12	4	-	-	-	-	16	-	-	-		
Mount Usher	394	36.5	22.8x17.3	6.95x5.26	7	2	-	-	-	-	-	-	-	-		
Pre Function Space	5,812	540	-	-	-	-	-	-	-	-	-	-	-	-		
Heritage Suite	1,247	115	43x29	13.1x8.8	-	-	100	96	96	60	30	36	36	48		



GUEST ROOM AMENITIES

Marble bathroom and signature Powerscourt bath essentials

Separate rainforest showers

Separate WC

Large sitting area or room in each suite

Double vanities

Electronic finger tip panels for controlling lighting and air-conditioning

Plush bathrobes

High-speed complimentary WiFi

Recessed TV in the bathrooms

Fully stocked honour bar

Safety deposit box

Interactive TV's in the bedroom and the sitting room

24h in-room dining

Multi-line telephones with voicemail

Daily housekeeping service

Accessible rooms available

Daily newspaper available

Tea and Coffee making facilities

RESORT AMENITIES

A 2,790-sq metre/30,000-sq ft Spa with 20 Treatment rooms

A 20-metre Swarovski crystal-lit indoor pool, state-of-the-art Thermal Suite

Fitness Suite available 24 hours

Complete Concierge services

36 hole Championship quality Golf Club

Landscaped Gardens and Historic House dating back to 1731

The River Walk, a private 5km scenic walk within the estate

Scenic mountain walking trails

Complimentary bicycle hire

Off road 4x4 driving

Team building activities such as archery and laser clays

Trout and salmon fishing/ fly fishing (nearby)

Horse riding for all skill levels (nearby)

Falconry

WEATHER

Spring (Mar, Apr, May):

High 12°C/53°F; low 5°C/41°F

Summer (June, July, Aug):

High 20°C/68°F; low 11°C/51°F

Autumn (Sept, Oct, Nov):

High 13°C/56°F; low 7°C/45°F

Winter (Dec, Jan, Feb):

High 8°C/46°F; low 3°C/37°F

NEARBY ATTRACTIONS

Powerscourt Estate and Gardens, 47 acres of magnificent formal gardens (on the resort)

Powerscourt Distillery located on the resort, offering whiskey tasting and distillery tours

Powerscourt Waterfall, Ireland's highest, where waters cascade to the Dargle River below (6km/3.5 miles away)

Glendalough, the ancient lakeside monastic settlement founded by St. Kevin (29km/18 miles away)

Brittas Bay, a delightful beach of powdery sand and coastal dunes (40km/25 miles away)

The Sally Gap and Wicklow Way, pathways of stunning mountain scenery (16km/10 miles away)

Guinness Storehouse, the story of the iconic black pint (25km/16 miles away)

SHOPPING

Avoca Handweavers, for traditional Irish clothing, household goods, cosmetics and farm produce (on the resort and at Kilmacanogue (5km/3 miles away))

Powerscourt Garden Pavilion, offering an exclusive array of items for home and garden (on the resort)

Dundrum Shopping Centre, Ireland's newest and most modern offering with prestigious stores (10km/6 miles away)

Grafton Street, Dublin's famously fashionable shopping venue featuring exclusive stores such as Brown Thomas (24km/15 miles away)



POWERSCOURT

HOTEL RESORT SPA

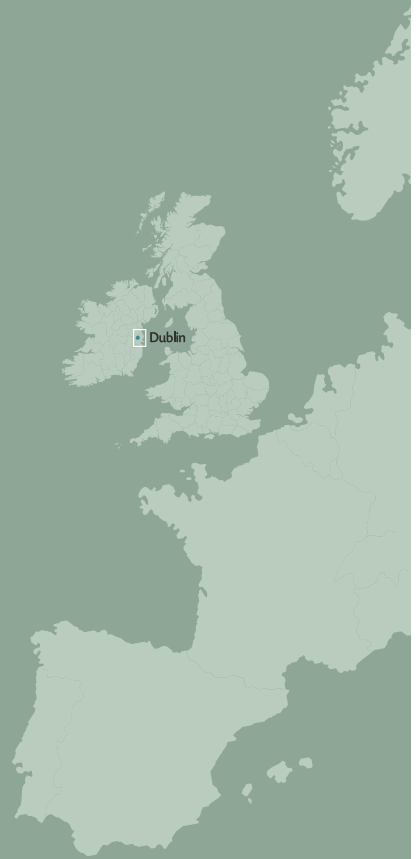

Powerscourt Hotel Resort Spa

Powerscourt Estate, Enniskerry, County Wicklow, Ireland.

www.powerscourthotel.com



GDS Codes –
Amadeus: DUBAKA, **Sabre:** 0048554, **Galileo:** 63424, **Worldspan:** DUBAK



AUTOGRAPH
COLLECTION®
HOTELS